



# Data Sheet

## Noise-Lock® STC 61 Steel Acoustic Door



### Overview

- Certified performance rating
- Manufactured to standard and custom sizes
- Available as single leaf or double door sets with glazing options
- Cam-lift hinges used to maximize acoustic seal
- Rugged steel construction
- Factory assembled and checked
- Finished in polyester powder coating as standard
- Wood veneer and powder coat finish options available
- Door leaf is 3 1/2" thick

### Acoustic Rating

STC 61 (dB) to achieve minimum NIC 56 once installed (subject to flanking).

Rw [C; Ctr] 59 (-4 ; -12) dB to achieve minimum R'w54 dB once installed (subject to flanking).

Certified laboratory performance in single leaf arrangement as follows:

Frequency (Hz)	63	80	100	125	160	200	250	315	400	500	630	800	1000	1250	1600	2000	2500	3150	4000
Noise-Lock® STC 61	22	28	28	41	51	54	53	55	55	60	62	60	60	61	61	62	64	66	69

#### Standard Features



Acoustic Rated



Easy Access Flat Thresholds

#### Optional Extras



Blast Resistance



RF Shielding



Fire Rated

## Overview

IAC Acoustics produces an engineered system — fully factory assembled complete with a leaf, architectural split-frame, acoustic seals, cam-lift hinges and hardware. All doors are pre-hung for operational alignment, fit and finish before shipping.

Noise-Lock® doors are laboratory-tested for performance in independent laboratories, further supported by installed site testing. IAC Acoustics is renowned for quality, durability and guarantees in-field performance.

## Hardware

IAC Acoustics Noise-Lock® doors are available with a number of standard and custom hardware options. Please contact your local IAC Acoustics office for further details.

- ① Acoustic Seal
- ② Cam-lift Hinge
- ③ Boot Seal
- ④ Sill
- ⑤ Male Frame
- ⑥ Main Frame / Female Frame

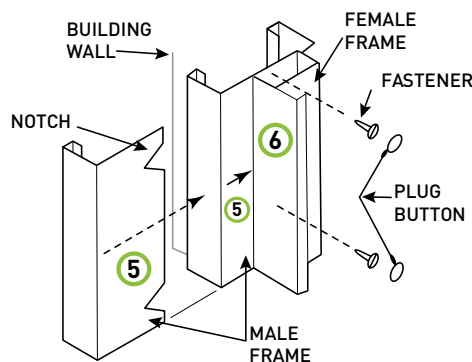
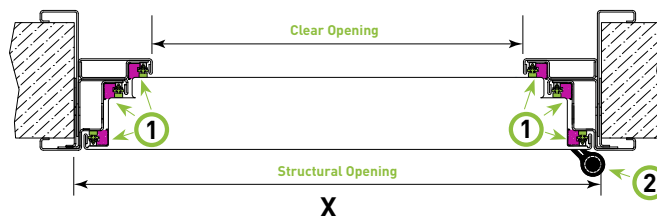
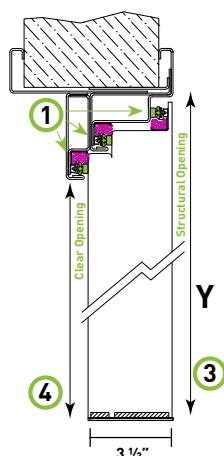

The relationship between the clear and structural openings for both width and height is the same for all sizes of Noise-Lock® STC 61 doors. An example for a 3' x 7' door can be found in the table below:

Door Opening	Width (X)	Height (Y)
Structural/Rough Opening	3' - 7 3/4"	7' - 4 1/8"*
Clear Opening	3'	7'

\* includes 1/4" threshold

## Performance Features

- Self-aligning magnetic seals assure long life and high in-field performance, even under constant use
- Cam-lift hinges lower and seal the door to the floor eliminating the high maintenance of automatic drop seals
- Split frames eliminate in-field grouting to achieve the specified acoustic performance with quick and clean installation